

- ✘ Thanks for selecting the EPEVER WiFi 2.4G RJ45 D adapter; please read this manual carefully before using the product.
- ✘ This product is not waterproof or dustproof. Do not use it in humid, high salt spray, corrosion, greasy, flammable, explosive, dust accumulative, or other severe environments.

WiFi 2.4G Adapter

EPEVER WiFi 2.4G RJ45 D

1. Overview

Through a local 2.4G WiFi network, the EPEVER WiFi 2.4G RJ45 D can transmit all operational data from the EPEVER solar controller, inverter, or inverter/charger to the EPEVER cloud server in real time. Users can remotely monitor the connected devices and program parameters via the EPEVER server platform and mobile APP.

- Applicable to EPEVER controllers, inverters, or inverter/charger with RJ45 port
- Use immediately after connecting; easy and convenient operation
- Directly powered by the communication port
- Up to 20 meters of communication distance
- Support the Local monitoring and "EPEVER Cloud" working mode.

2. Appearance

RJ45 connector



Indicator	Instruction
Green flashing fast (ON 0.3S, OFF 0.3S)	Power on only. Adapter's WiFi hotspot no connection, and no network access.
Green flashing slowly (ON 3S, OFF 0.3S)	Local connection only. Adapter's WiFi hotspot is connected.
Green ON	Remote control. Adapter is connected to router.

RJ45 connector pin definition

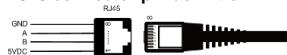

Pin	Definition	Pin	Definition
1	+5VDC	5	RS485-A
2	+5VDC	6	RS485-A
3	RS485-B	7	GND
4	RS485-B	8	GND

3. System connection

For devices with RJ45 com. port, connect the WiFi adapter directly without a cable.

For devices with non-RJ45 com. port, an additional converter is needed to purchase.



The WiFi adapter working voltage is 4.5V-5.5V and peak emission is 150mA. Exceeding this voltage range may damage the adapter!

4. APP operation

Add the WiFi adapter and the connected device to the cloud server by website (<https://hnccloud.epsolarpv.com>) or APP. Then you will be able to monitor the device and set parameters by PC or APP (the following takes APP as an example).

1. **Download APP** (The WiFi adapter only supports the Solar Guardian and cannot be connected to other servers.)



2. **Register & Login**

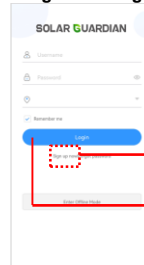

1 Register

Download the APP and open it, click the "Sign up now" icon. Input the user name, email, verification code, and password, and then select the user type and system type from the drop-down box. Tick to agree with the privacy agreement and click the "Sign Up."

2 Login

After registering, return to the APP. Input the user name and password, select country, tick the "Remember me" to log in quickly next time, and click the "Login" button to enter the APP.

3. **Add device (There is a local 2.4G WiFi network)**

Step1: Turn on the WiFi switch on the phone, and connect to the local WiFi network (a 2.4G WiFi network is a must).

Step2: Login to the APP and click the icon to add a new gateway.

Step3: Select the gateway model.

Step4: Input the gateway data ("**Gateway SN**" is the **22-digit number of the gateway WiFi**), and click "Next Step" to enter the device adding page.

Step5: After adding the device, click "Next Step" to enter the above page.

Step6: Input the local WiFi password and click "Next Step."

Step7: Click "Go to set up Wi-Fi" to connect phone to the gateway WiFi (HN_EPSN: xxxxxx, password: 12345678). Return to the APP after connection, and click "Next Step."

Step8: After the gateway is successfully connected, connect the phone to local WiFi or 4G that can access the Internet. Then you can monitor the device through the APP.

4. Add device (There is no local 2.4G WiFi network)

Step1: Login to the APP and click "My > Collect Data." Select all products and click the "Synchronize data" to download data.

Step2: After all data is downloaded, return to the APP. Click the "Home > Offline."

Step3: Select the adapter type (WiFi)

Step4: Turn on the phone WiFi switch and connect the phone to the gateway WiFi (HN_EPSN: xxxxxx, password: 12345678).

Step5: Return to the APP and click "Equipment->Add equipment" ("**Gateway SN**" is the **22-digit number of the gateway WiFi name**). Click "Confirm" to add the device.

Step6: On the "Device List" page, click the gateway SN to enter the device's real-time monitoring page.

5. Specifications

Parameter	Model	EPEVER WiFi 2.4G RJ45 D
Working voltage		5V± 0.5V(Powered by RS485 com. port)
Power consumption		Peak emission: 150mA; Idle: 310uA
Enclosure		IP30
Communication method		RS485

Communication parameters	115200Bps, 8N1
Interface standard	EPEVER communication standard V1-1.0
Work frequency	2.4 ~ 2.4835GHz
Work temperature range	-40°C~ 85°C
Dimension	63mm x 19mm x 13.8mm
Net weight	7.7g

Any changes without prior notice! Version number: V1.3